

© STRINGENT COPYRIGHT:
This drawing has been produced for:
Let Manager Ltd.

and prepared for submission as part of any statutory Applications. It is not intended for use by any other person or for any other building project or purpose without prior permission from Toldfield Architects Ltd.

RIBA CHARTERED ARCHITECTS

PROPERTY No 102

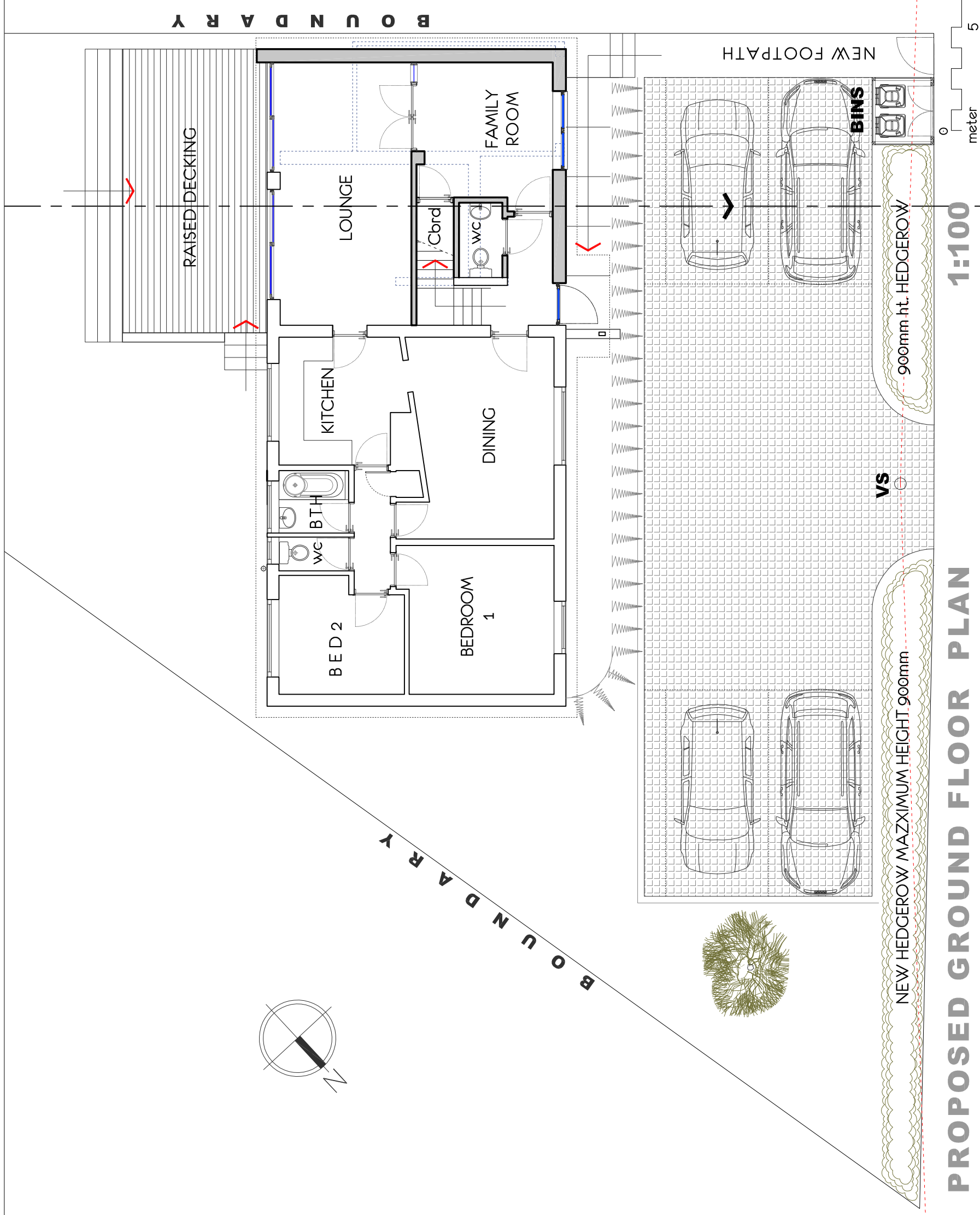

PROPOSED GROUND FLOOR PLAN

<p>TOLDFIELD ARCHITECTS</p> <p>Toldfield Architects Ltd 5 Freemantle Business Centre 152 Millbrook Road East Southampton SO15 1JR Tel: 023 80 236165</p> <p>Client: Let Manager Ltd.</p> <p>Drawing Title: Proposed ground floor plan</p>	<p>Project Name and Address: Proposed new roof over existing dwelling flat roofs to form a larger 4-Bedroom dwelling @ 100 Rownhams Rd, N/ Baddesley</p>	<p>Project Ref: 201101</p>	<p>Origin: TA</p>	<p>Zone: 01</p>	<p>Level: 01</p>	<p>Type: P</p>	<p>Role: A</p>	<p>Number: P05</p>	<p>Rev:</p>
	<p>Status: Final Design</p>	<p>Project Stage: Project Stage</p>	<p>Sheet @ A3: Sheet @ A3</p>	<p>Date: Nov 2020</p>	<p>Rev:</p>	<p>Comments:</p>	<p>Dr:</p>	<p>Ch:</p>	